

2 TILE @ ENTRY MAT
SCALE: 6" = 1'-0"

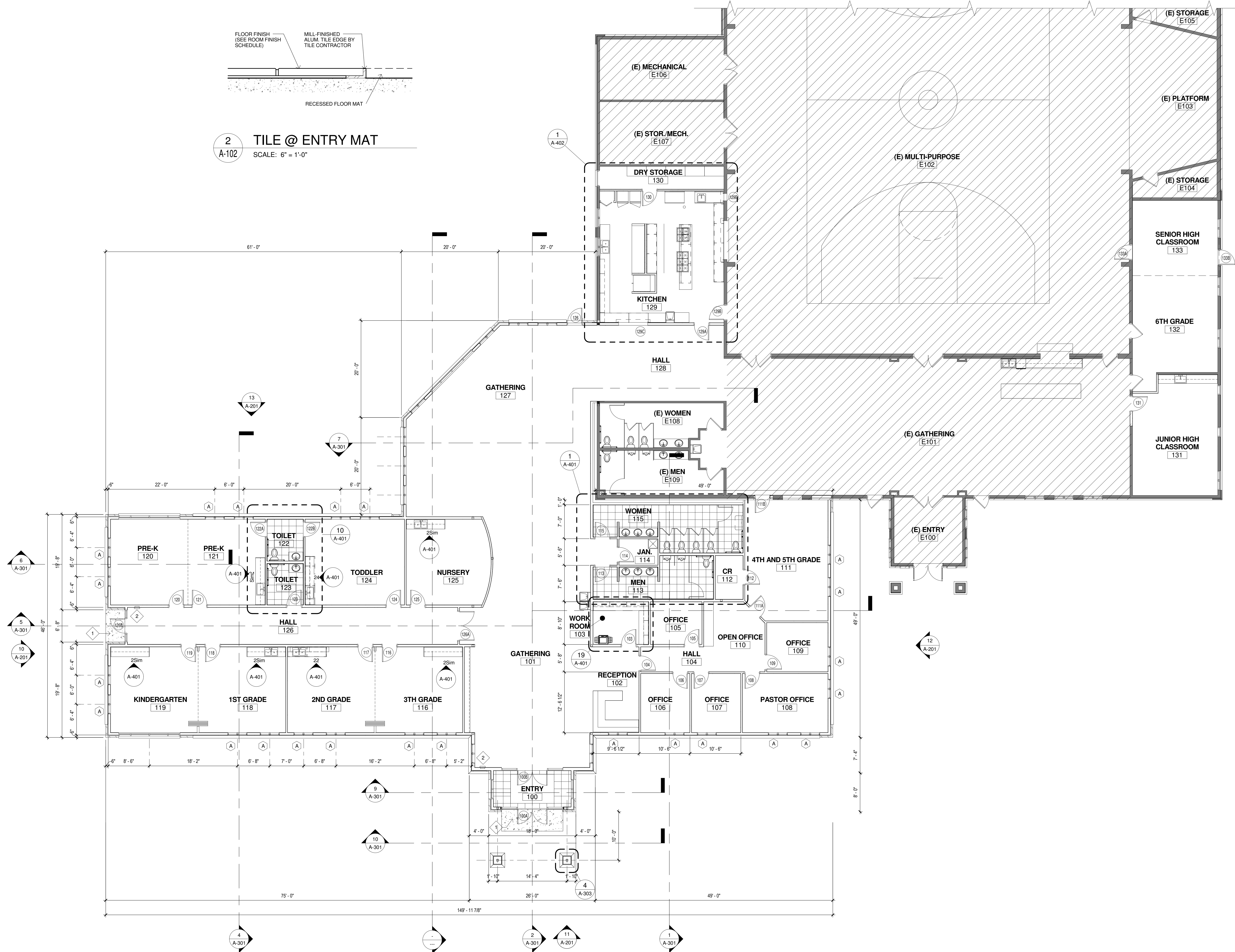

FLOOR PLAN SYMBOL LEGEND

- NEW POINT ELEVATION
- EXISTING POINT ELEVATION
- EXISTING CONTOUR
- NEW CONTOUR
- PROPERTY LINE
- SETBACK LINE
- LIGHT POLES & LIGHTS
- FIRE HYDRANT
- EXISTING POWER POLE
- EXISTING LIGHT POLE
- EXISTING TELEPHONE PEDESTAL
- ACCESSIBLE PARKING
- EXISTING BUILDING

GENERAL NOTES

1. T/S LAB ELEVATION OF 100'-0" - AS SHOWN ON CIVIL DRAWINGS
2. ALL INTERIOR STUD PARTITIONS & FURRING SHALL BE DIMENSIONED TO THE FACE OF STUD OR FURRING UNLESS OTHERWISE NOTED.

FLOOR PLAN KEYNOTES

- 1 CONCRETE STOOP (SEE STRUCTURAL)
- 2 SEMI-RECESSED FIRE EXTINGUISHER CABINET (SEE DETAIL X/A-XXX)
- 3 CARPET TERMINATION STRIP
- 4 CONDENSING UNITS - SEE MECHANICAL
- 5 KEYED TYPE HOSE BIB (SEE MECHANICAL)
- 6 LINE OF EAVE, SOFFIT OR CANOPY ABOVE (SEE DETAIL X/A-XXX)
- 7 RECESSED BUILDING ENTRANCE MAT (SEE DETAIL X/A-XXX)
- 8 COAT RACK (SEE DETAIL X/A-XXX), PROVIDE SOLID BLK'G IN WALL
- 9 TRANSFORMER (SEE ELECTRICAL)
- 10 LINE OF WALL OR COLUMN BELOW
- 11 CARPET TERMINATION STRIP
- 12 ELECTRIC WATER COOLER (SEE DETAIL 11/A-401)
- 13 PREFINISHED METAL DOWNSPOUT W/ CONCRETE SPLASHBLOCK
- 14 ROOF DRAIN LEADER & OVERFLOW DRAIN LEADER
- 15 MECHANICAL / ELECTRICAL CHASE
- 16 SUMP PIT - SEE MECHANICAL & ELECTRICAL FOR LOCATION, PUMPS, AND POWER REQUIREMENTS. (SEE DETAIL X/A-XXX)
- 17 DRAIN TILE BY EXCAVATION CONTRACTOR (SEE DETAIL X/A-XXX & MECH DRAWINGS)
- 18 POWER ASSIST PUSH PAD MOUNTED ON BOLLARD
- 19 WALL-MOUNTED POWER ASSIST DOOR PUSH PAD
- 20 CONCRETE FILLED STEEL BOLLARDS AT REMOTES AND ATM (SEE DETAILS X/A-XXX & X/A-XXX)
- 21 DRIVE-THRU SIGN (SEE DETAIL X/A-XXX)
- 22 DRIVE-UP TELLER WINDOW, REMOTES, DRAWER, AND ATM BY BANK EQUIPMENT SUPPLIER. FINISHES AROUND WINDOW, INSULATING, AND SEALANT BY RESPECTIVE SUBCONTRACTORS.
- 23 PRE-MANUFACTURED 9'-10" X 16'-10" (OUTSIDE DIMS) VAULT AND DOOR TO BE INSTALLED BY BANK EQUIPMENT SUPPLIER - GROUT, SEALANT, AND FINISHES BY RESPECTIVE SUBCONTRACTORS
- 24 CHECK DESK - SEE DETAILS ON A-XXX
- 25 NIGHT DEPOSITORY LOCATION - COORDINATE WITH BANK EQUIP SUPPLIER (SEE DETAIL X/A-XXX)
- 26 5/8" GYP BD OVER 2X WOOD FURRING AT INSIDE CONCRETE VAULT WALLS
- 27 LINE OF STAIR & LANDING ABOVE

VANMAN Architects and Builders
 669 WINNEKA AVENUE NORTH - SUITE 210
 MINNEAPOLIS, MN 55427
 (763) 541-9852 FAX: (763) 541-9857
 INTERNET: www.vanmanab.com
 COPYRIGHT © 2010

PRELIMINARY NOT FOR CONSTRUCTION

I HEREBY CERTIFY THAT THIS PLAN SPECIFICATION OR REPORT WAS PREPARED BY ME OR UNDER MY SUPERVISION AND THAT I AM A FULLY LICENSED ARCHITECT UNDER THE STATE OF MINNESOTA.
 PRINT NAME: [Signature] ARCHITECT
 SIGNATURE: [Signature]
 DATE: [Date] REGISTRATION # [Number]

ISSUE DATE: October 25, 2010
 REGION # [Number] DATE [Date]

MAIN FLOOR PLAN

ADDITION AND REMODEL FOR:
LAKE COMMUNITY CHURCH
 1751 County Rd 44 NW
 Alexandria, MN 56308

A-102
 A0816

